

## MOBOTIX T25 6MP Hemispheric Camera

**MOBOTIX**  
Access Control included

**IK09**

**Weatherproof**

Security-Vision-Systems  
**MOBOTIX**

*IP Video Door Station in triple frame with BellRFID and Info Module*

**180°**

*Hemispheric video: 180° wall-to-wall capture, no blind spots.*

Technical specifications subject to change without notice

### The World's Most Advanced Door Station.

This modular IP Video Door Station, a one-of-its-kind, offers a combination of 6MP Hemispheric technology and integrated VoIP/SIP to provide full access control and a two-way video communication option – at home or via a mobile app while on the go.

**Technical specifications subject to change without notice.** For more information on the T25 and on the entire range of MOBOTIX products, such as prices, manuals, video management software for computers and iOS devices, etc., please go to [www.mobotix.com](http://www.mobotix.com) > **Products**. Or contact us by phone (+49 06302 9816-103) or email (sales@mobotix.com).



## Hemispheric Video

Capturing a super-wide 180° field of view, the T25 camera module captures everything wall-to-wall for secure viewing and recording. The Hemispheric image correction is handled by the camera, no external PC required. The in-camera image correction saves bandwidth by up to 70 %.



## Instant 2-Way Communication – From Anywhere!

SIP/VoIP built-in for Instant 2-way intercom communication. If the bell button is pressed, the camera records and a phone call or message can be sent directly to your PC, mobile or phone. A conversation can be initiated with the visitor, from wherever you are in the world.



## Secure Access with RFID and Messaging

With the door station modules, keyless RFID and PIN access can be added to ensure secure door entry at all times. Visitors can leave voicemails and message retrieval is done instantly locally or remotely.

## Technical Data

<b>Lens Options</b>	B016	<b>Min. Light Sensitivity</b>	Day Sensor: 0.1 lux at 1/60 sec Night Sensor: 0.02 lux at 1/60 sec
<b>Image Sensors</b>	1/1.8" CMOS (6MP) Day (Color) or Night (B&W)	<b>Sensor Resolution</b>	6MP: 3072x2048 pixels (Color/B&W)
<b>Max. Frame Rate (MxPEG)</b>	MEGA/HD: 30 fps, QXGA: 15 fps, 6MP: 8 fps	<b>Compression</b>	MxPEG, M-JPEG, JPEG, H.264 (SIP video only)
<b>DVR Recording</b>	Internal: microSD Card External: PC/NAS	<b>Audio</b>	Integrated microphone & speaker, VoIP, intercom, sound recording
<b>Operating Conditions</b>	IP65, IK09, -30 to +50 °C	<b>Internal Sensors</b>	Temperature, microphone, illumination, shock detector.
<b>Image Processing</b>	MxActivitySensor, VMD, image correction, backlight, MxAnalytics	<b>Software (free of charge)</b>	MxManagementCenter, MOBOTIX App



# T25 – Technical Specifications

Security-Vision-Systems

**MOBOTIX**

Camera Variants	T25 Day	T25 Night
<b>Lenses, Sensors</b>		
Fisheye Lens MX-B016 (Hemispheric, 180° x 180°)	MX-T25-D016 (white) MX-T25-D016-s (silver) MX-T25-D016-d (dark gray) MX-T25-D016-b (black)	MX-T25-N016 (white) MX-T25-N016-s (silver) MX-T25-N016-d (dark gray) MX-T25-N016-b (black)
Ultra Wide Lens MX-B036 (103° x 77°)	–	–
Super Wide Lens MX-B041 (90° x 67°)	–	–
Wide Lens MX-B061 (60° x 45°)	–	–
Standard Lens MX-B079 (45° x 34°)	–	–
Tele Lens MX-B119 (31° x 23°)	–	–
Distant Tele Lens MX-B237 (15° x 11°)	–	–
Super Tele Lens MX-B500 (8° x 6°)	–	–
CS-Varioobjektiv MX-B045-100-CS (39°-89° x 29°-65°)	–	–
Camera Module (body), lens can be ordered separately	–	–
Image sensor with individual exposure zones	Color	B/W
Sensor sensitivity in lux at 1/60 s /1 s	0,1/0,005	0,02/0,001

Hardware Functions		
Protection class	IP65 and IK09	IP65 and IK09
Ambient temperature (range)	-30 to 50°C/-22 to 122°F	-30 to 50°C/-22 to 122°F
Temporary internal DVR	•	•
Internal DVR, ex works	4 GB (microSD)	4 GB (microSD)
Microphone/speaker	•/•	•/•
Passive infrared sensor (PIR)	With accessory (e.g., MxExtIO)	With accessory (e.g., MxExtIO)
Integrated temperature sensor	•	•
Shock detector	•	•
Power consumption (typical)	< 4,5 watts	< 4,5 watts
Variable PoE class (factory default: 3)	2 or 3	2 or 3
Interfaces Ethernet/MxBus/USB	•/•/•	•/•/•
Interfaces IO and RS232	With T25 accessory (e.g., MX-OPT-IO1)	With T25 accessory (e.g., MX-OPT-IO1)

Image Formats, Frame Rates, Image Storage		
Maximum image format (per sensor)	6MP (3072 x 2048)	6MP (3072 x 2048)
Maximum frame rate (MxPEG, max. resolution)	8 fps (6MP)	8 fps (6MP)
CIF images with 4 GB MicroSD DVR	250,000	250,000
VGA images with 4 GB MicroSD DVR	125,000	125,000
HD images with 4 GB MicroSD DVR	40,000	40,000
QXGA images with 4 GB MicroSD DVR	20,000	20,000

## Safety Warning: Risk Of Overheating When Exposed To Direct Sunlight

When mounting a black, dark gray or amber-colored T25 IP Video Door Station (amber no longer available) in locations where the device is exposed to **direct sunlight**, the housing temperature can exceed the maximum allowed temperature limit. This can result in electronic failures and injuries especially when touching exterior metal parts. If the intended use of the device is at an (unprotected) outdoor location, you should only install **white or silver-colored** modules and frames. This product must not be installed within the reach of persons without the dome.



Camera Variants	T25 Day	T25 Night
<b>Allgemeine Funktionen</b>		
Door station functionalities	•	•
Digital zoom (continuous) with panning	•	•
Codecs: Motion-JPEG/MxPEG/H.264 for SIP	•/•/•	•/•/•
Programmable exposure zones	•	•
Snapshot recording (pre/post-alarm images)	50	50
Terabyte ring buffer storage (internal/network)	•	•
Continuous recording with sound (0.2 to 30 fps)	•	•
Event recording with sound, only with accessory (e.g., AudioMount)	•	•
Time and event control/flexible event logic	•/•	•/•
Weekly schedules/holidays	•	•
Web functionality (FTP, email)	•	•
Playback/QuadView and MultiView	•/•	•/•
Bidirectional sound in browser, only with accessory (e.g., AudioMount)	•	•
Logo generator, animated	•	•
Master/Slave arming	•	•
Several scheduled privacy zones	•	•
Customized voice messages, only with accessory (e.g., AudioMount)	•	•
VoIP telephony (audio/video, alert), only with accessory (e.g., AudioMount)	•	•
Remote alarm notification (network message)	•	•
Signal inputs/outputs and RS232 via MxBus module	•	•
Programming interface (HTTP API)	•	•
Security Features (HTTPS/S/L, IP-based access control, IEEE 802.1X network authentication)	•	•

Video Analysis		
Video motion detector	•	•
MxAnalytics	•	•
MxActivitySensor (incl. behavioral detection)	•	•

Video Management Software		
MxManagementCenter	•	•
MOBOTIX App	•	•

- available ex works
- not available



**Comparable standard colors (not exactly the MX colors):**  
 White: RAL 9016, Silver: RAL 9006, Dark Gray: DB 703, Black: RAL 9005

When **switching cameras** to the T25-6MP or S15M-6MP with an existing Door Station (T24, T25, S14 or S15 up to 5 MP), **continued use** of the remaining outdoor station modules is possible if the user performs a system reconfiguration.

However, due to technical reasons, it is necessary to exchange an older existing T24-DoorMaster for the new **MX-DoorMaster** (article number: MX-Door2-INT-PW).

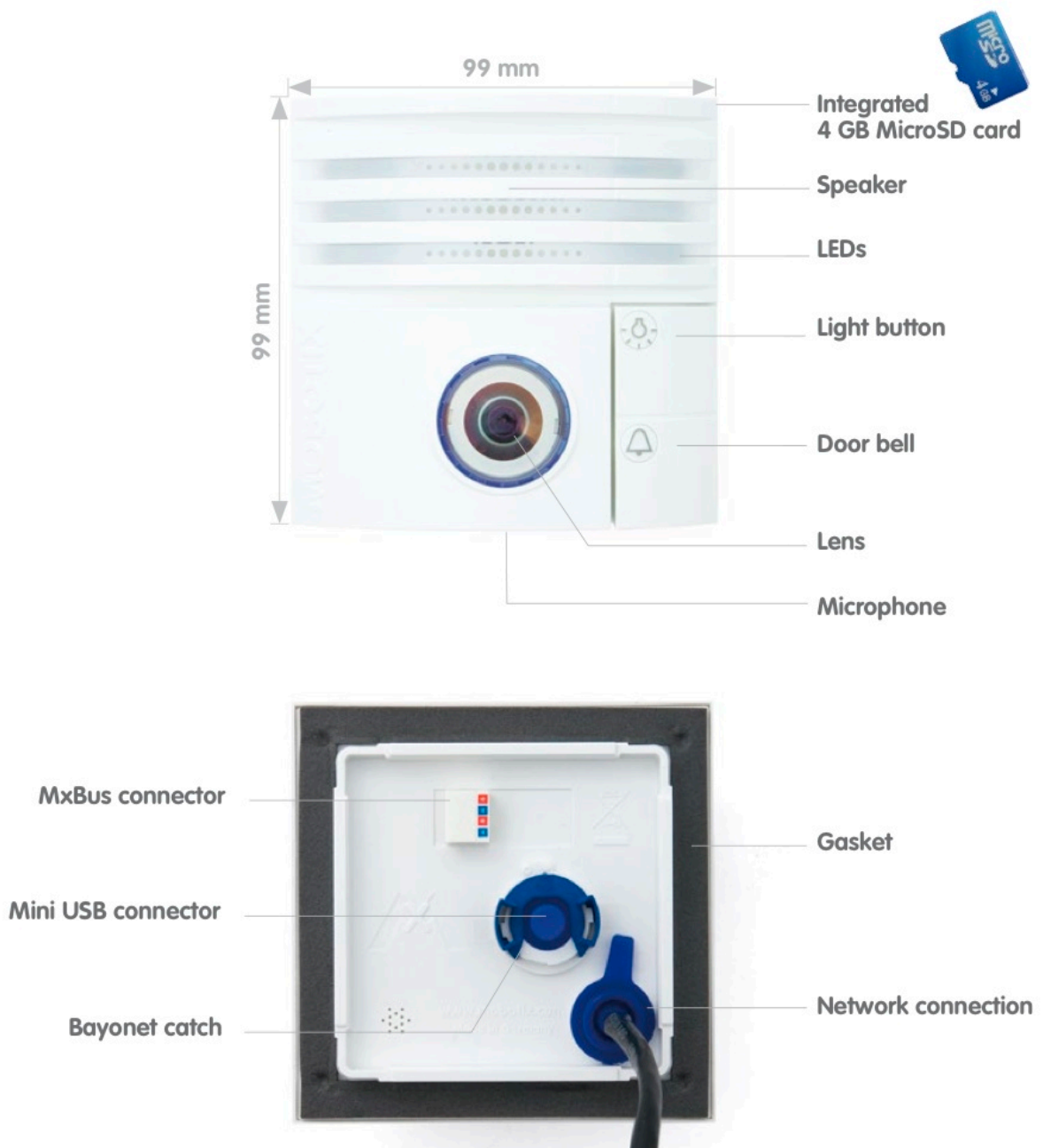

(T25 – Camera housing and connectors, excerpt from the technical documentation)

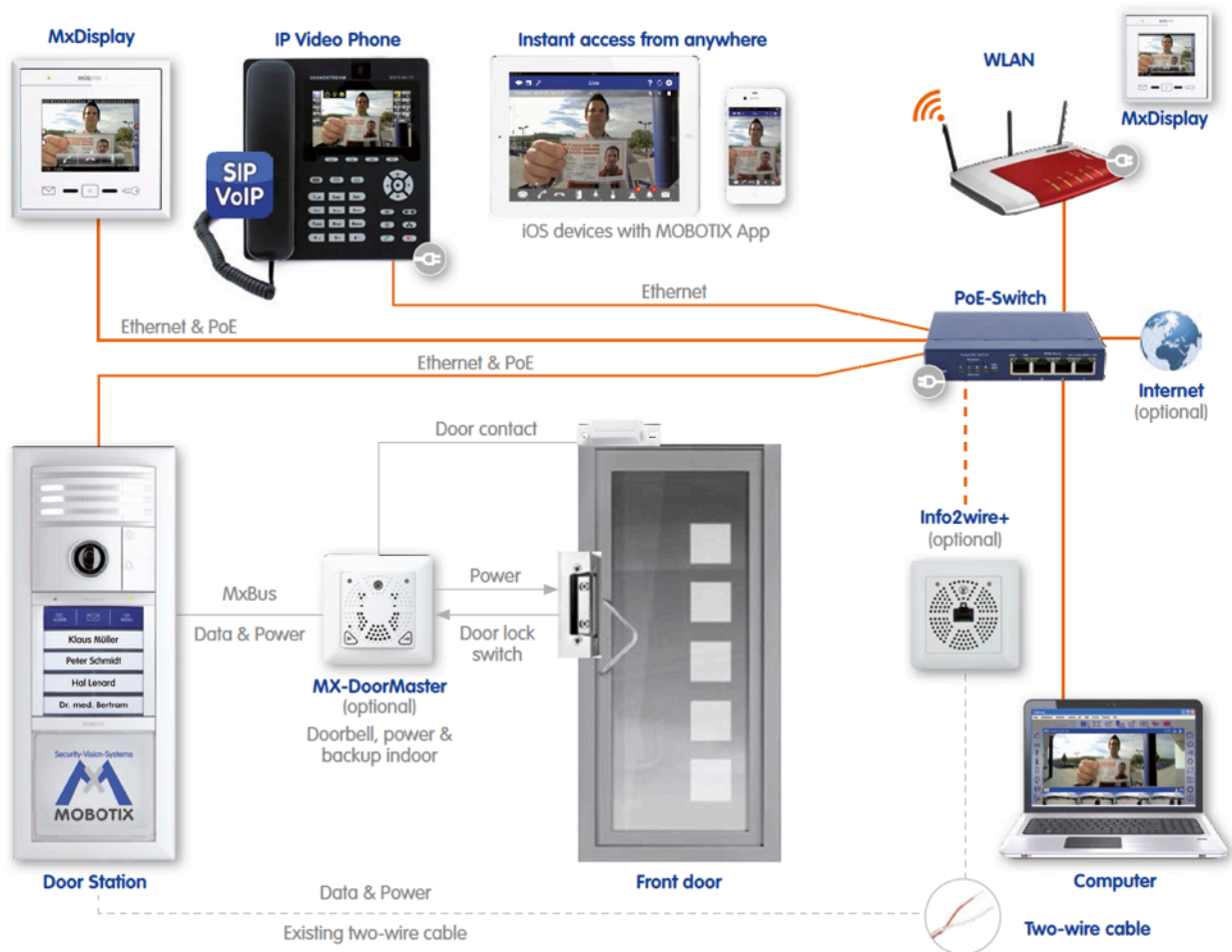

## Hemispheric IP Video Door Station – Fast, Cost-Effective Installation

Existing doorbells and intercoms can be replaced with a MOBOTIX Door Station, because it's an end-to-end solution that can be installed anywhere, even if there is no existing network infrastructure, using Mx2wire+. Any number of additional video and access devices can be integrated to create a door access control solution that can be controlled from any location.

The outdoor station requires just one cable for data and power to be connected to a PoE switch and thereby to any expandable Ethernet network. The T25 core module is also fitted with an internal MicroSD storage for convenient on-board storage, or alternatively can record to networked storage (NAS or PC).

## T25 Smart Access Set 1



### A Perfect Match

The **T25 Smart Access Set 1** with T25 IP Video Door Station and MxDisplay+, the video remote station, are available for immediate use after installation because it is **completely preconfigured** in the MOBOTIX factory. The set offers home owners, in particular, the ideal way to start implementing a smart home, while improving comfort and safety for the whole family.

The MxDisplay+ is used to set the doorbell signals including the configurable sound and live color image. The high-resolution door camera captures the entire entryway with no blind spots using its 180° panorama view. The home's inhabitants can speak with visitors with digital sound quality and activate the electric door opener with a tap on the display's touchscreen. The bell button module in the outdoor station makes it possible for the home's inhabitants to gain keyless entry to the home thanks to integrated RFID technology. The product ships with six preconfigured user RFID transponder cards that can be used right out of the box. They are activated for the specific Smart Access Set only.

#### Scope Of Delivery: T25 Smart Access Set 1 (MX-T25-SMART-SET1)

T25 6MP CamCore with day sensor, white	Order Number: MX-T25-D016
BellRFID base module, white	Order Number: MX-Bell1-Core-EXT-PW
Large bell button with function button	Order Number: MX-Bell1-Button-F1
Ethernet connection board	Order Number: MX-OPT-IO2
Double frame, white	Order Number: MX-OPT-Frame-2-EXT-PW
On-wall housing in double frame, white	Order Number: MX-OPT-Box-2-EXT-ON-PW
Double in-wall housing	Order Number: MX-OPT-Box-2-EXT-IN
MxDisplay+, white (without admin card)	Order Number: MX-Display2-EXT-PW
Flat mount frame, white	Order Number: MX-OPT-FlatMount-EXT-PW
In-wall housing for flat mount frame	Order Number: MX-OPT-FlatMount-Box-Ext-IN
1 admin RFID transponder card (red)	Order Number: MX-AdminCard1
6 user RFID transponder cards (blue)	Order Number: MX-UserCard1
Overhead marker	(not a MOBOTIX product)

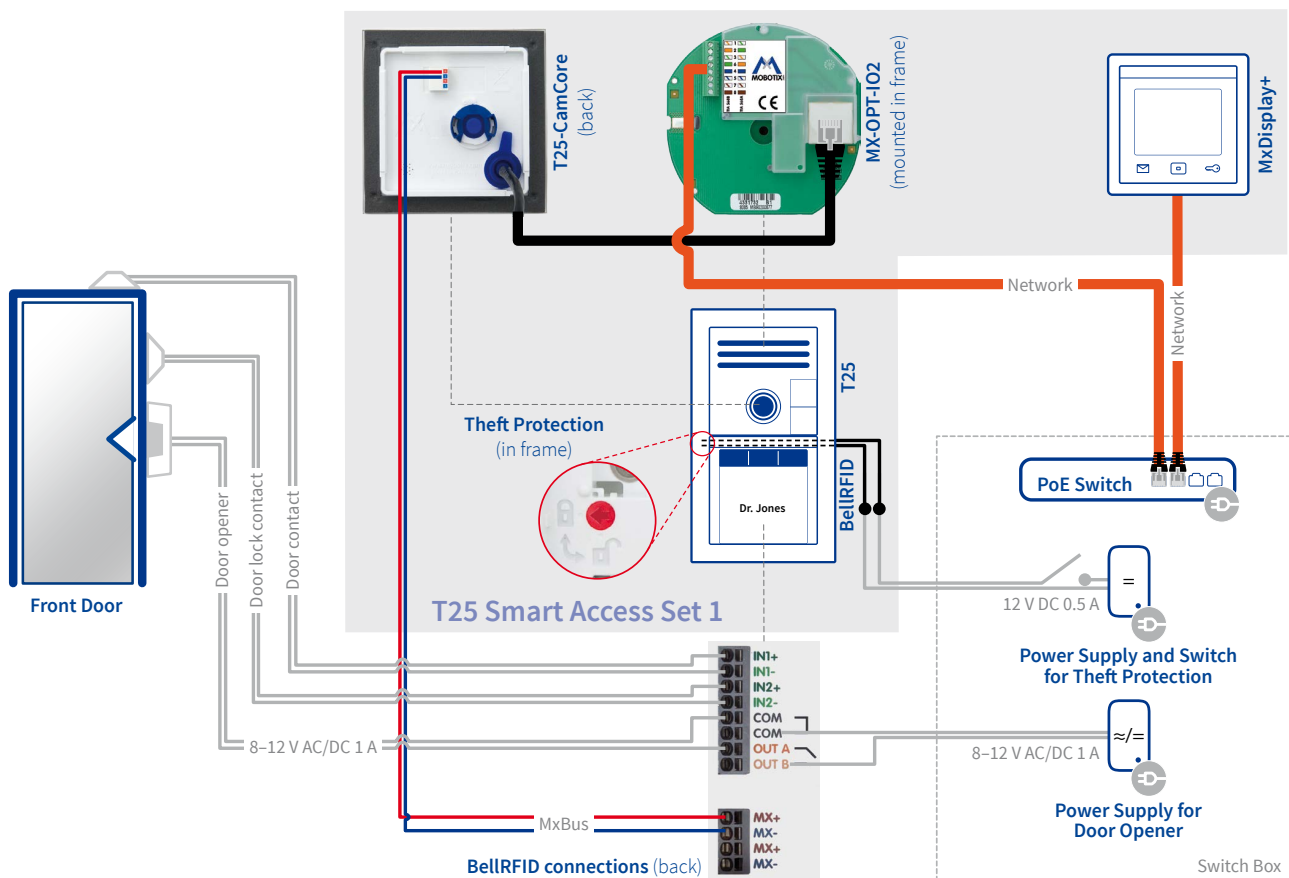

## Ordering Information For T25 Smart Access Set 1:

Order Number	EAN	Description
MX-T25-SMART-SET1	4047438028769	<b>T25 IP Video Door Station with MxDisplay+ as preconfigured complete set for use in family homes</b> • Delivery outdoor remote station (IP65, -30 to 50°C, -22 to 122°F): CamCore T25 with 6 Megapixel Moonlight Sensor, color (day) and Fisheye Lens B016 (focal length 1.6 mm, f/2.0, 180° × 180°) • BellRFID module with one big key with blue functional bar, 1x admin and 6x user card, MX-OPT-IO2 Ethernet board, double frame set for in-wall or on-wall installation, pen for plastic film, mounting material • Delivery indoor remote station: MX-DISPLAY3, FlatMount Frame with In-Wall-Housing • All devices and frames colored in <b>white</b>

### Note:

You will find all available MOBOTIX door station/building automation products (sets, individual products and accessories) in the current price list (pdf) on our website: [www.mobotix.com](http://www.mobotix.com) > **Products** > **Price List**

